



800.390.2301 Phone or Fax

www.LBKSkylight.com

::AUSTIN:: 512.320.9972

::OKC:: 405.445.3487

::CORPORATE OFFICE | 701 N Interstate 27 | Lubbock, TX 79403 | 806.744.2300::

### RIDGE MOUNT SKYLIGHT

Top View Without Mullions

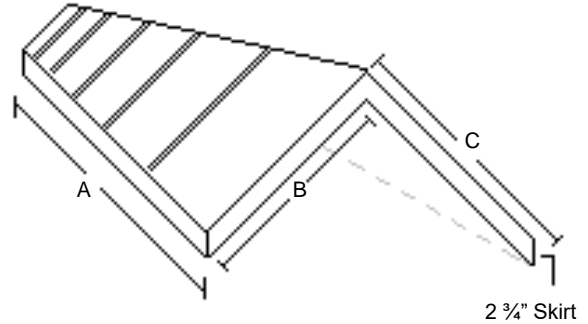
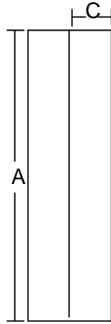

**SPECIFICATIONS::** Ridge Mount Skylights shall be manufactured by LBK Skylight Manufacturing [(800) 390-2301]. Each skylight shall be factory assembled with acrylic, polycarbonate or insulated glass glazing. Finish shall be natural aluminum (mill), bronze or custom color. Skylight is designed and manufactured to meet or exceed standard of 40 psf live load and 20psf (uplift). ALL UNITS ARE GUARANTEED AGAINST DEFECTIVE WORKMANSHIP AND MATERIAL.

QTY	MEASUREMENTS		
	A (LENGTH)	B (ROOF PITCH)	C (LEG LENGTH)

QTY	MEASUREMENTS		
	A (LENGTH)	B (ROOF PITCH)	C (LEG LENGTH)

GLAZING PLACEMENT	DOME MATERIAL						COLOR					MATERIAL THICKNESS
	ACRYLIC	COMMERCIAL DUTY	100%DR	POLYCARBONATE	STRUCTURED POLYCARBONATE	INSULATED GLASS	WHITE (LAMINATE FOR IG)	BRONZE	CLEAR	GRAY (INSULATED GLASS) CUSTOM COLOR FOR ALL OTHER OPTIONS	CUSTOM COLOR	FRAME FINISH
												NATURAL ALUMINUM (MILL)
OUTER												BRONZE PAINT
INNER												CUSTOM COLOR

NOTES

PROJECT NAME	PO / JOB #	LEAD TIME (IN WEEKS)	TODAY'S DATE
PROJECT DELIVERY ADDRESS	CITY / STATE / ZIP	SITE CONTACT / PHONE	
REQUESTED BY	PHONE	COMPANY	
ADDRESS	CITY / STATE / ZIP	APPROVAL SIGNATURE	

RIDGE MOUNT\_LSM 021318